

WHIPSHOT

Instructions and safety Manual



Read and follow all safety warnings and instructions in this manual.

Retain instructions and safety manual for future reference.

WHIPSHOT INSTRUCTION MANUAL

Congratulations! You own a WHIPSHOT compound bow. The Whipshot excels in close-quarter tactical shooting, multiple target engagement and small game survival hunting when the rapid follow-up shot makes all the difference!

Please read and familiarize yourself with these starting procedures before shooting. Many of these procedures may have been completed by your dealer. A careful and thorough initial setup will make your shooting more accurate and assure you greater success from the start. With proper care, you will enjoy the use of this product for many years to come.

Bow Diagrams

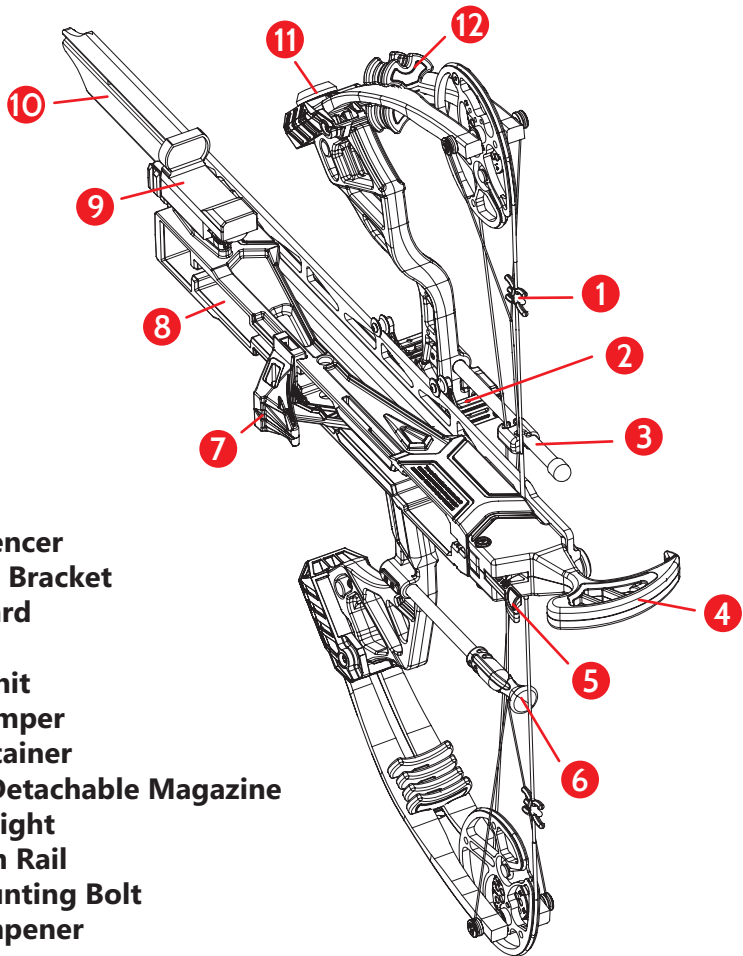

1. String Silencer
2. Mounting Bracket
3. Cable Guard
4. Handle
5. Trigger Unit
6. String Damper
7. Arrow Retainer
8. 6-Arrow Detachable Magazine
9. Red Dot Sight
10. Aluminum Rail
11. Limb Mounting Bolt
12. Limb Dampener

Package Includes :

- 6 x 15" Carbon Arrows
- 1 x Mounting Bracket
- 1 x Arrow Retainer Assembly
- 1 x Aluminum Red-Dot Sight
- 1 x String Silencer

Parts of the bow:

Magazine

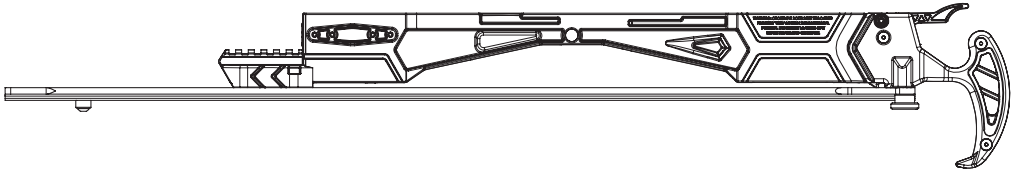

Arrow Retainer

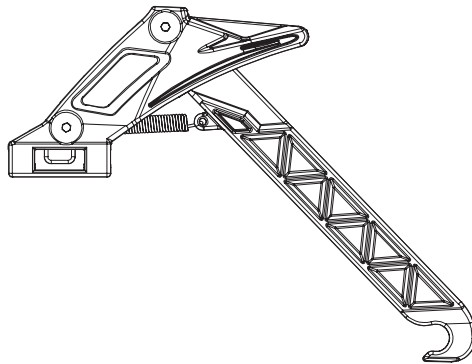

Mounting Bracket

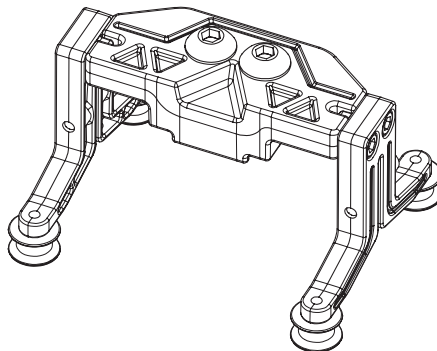

Assembly Guide

IMPORTANT : Make sure there's no D-ring or Nok-set on the string before installing your magazine, it will cause a dry-fire and damage your bow. The draw length should be set at 28" and the string should be waxed. The Mounting Bracket should be installed on the outer side of the bow. Make sure the installation position is correct, and lock the two screws on the riser properly.

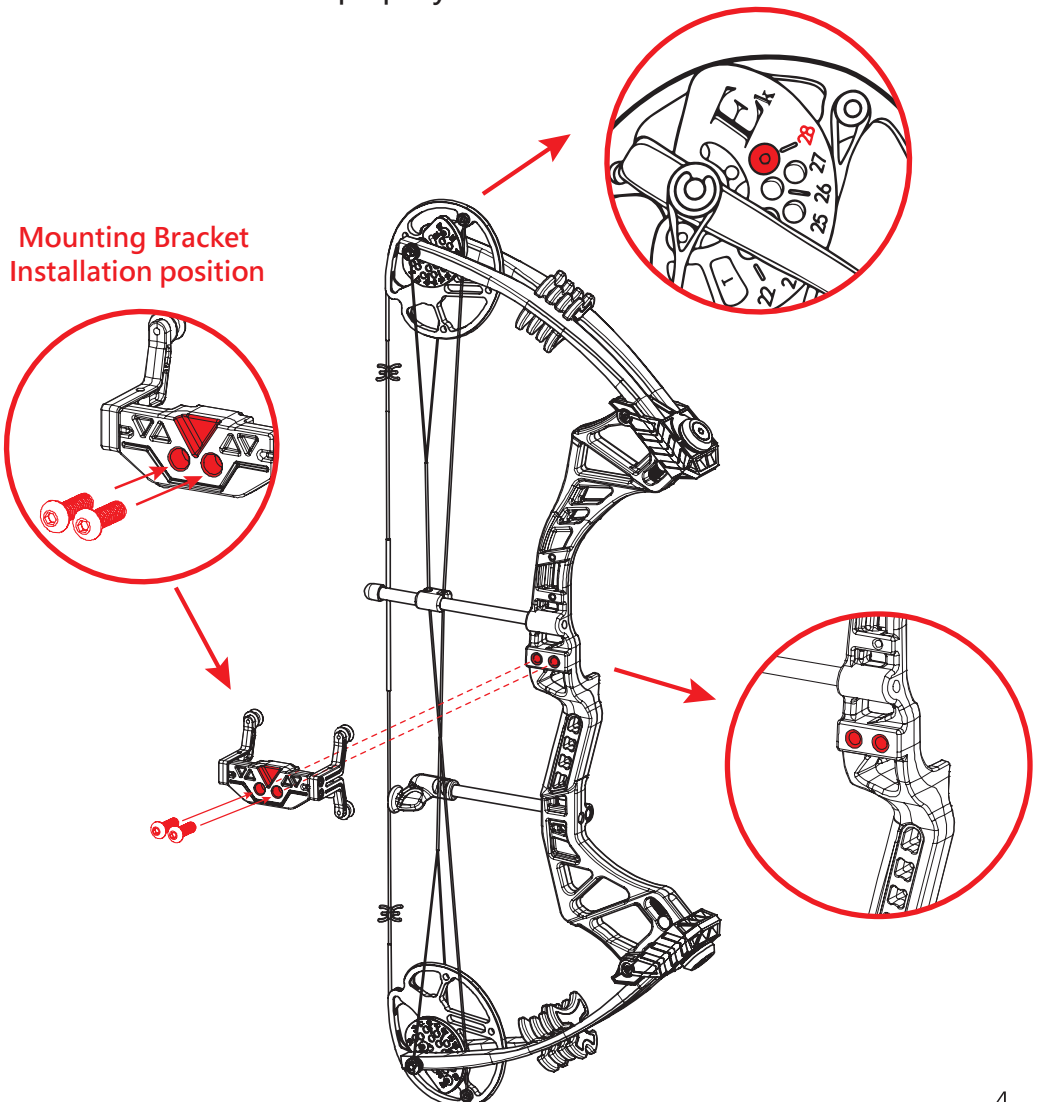

Mounting bracket assembly completed.

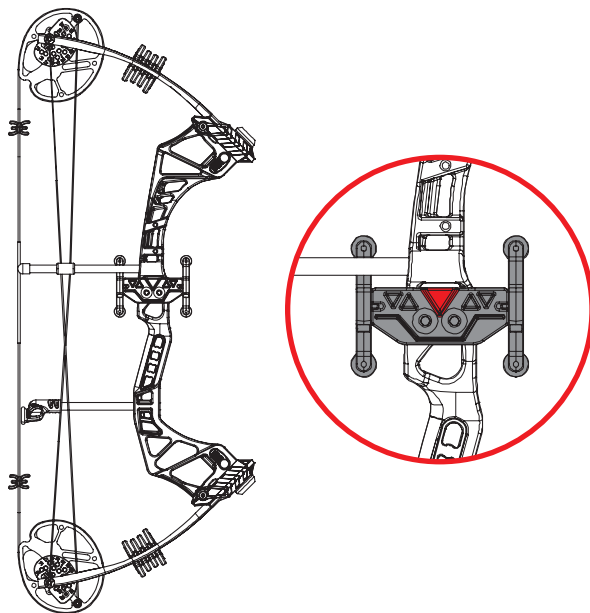

B **Step B-1~2 :** Remove the locking knob on the magazine and pull up the handle. **Step B-3 :** Install the magazine into the slide rail. The main string should be positioned between the rail and magazine (Warning : make sure the four sides of the slide rail are in position) **Step B-4~5 :** Fasten the locking knob on the handle in the correct position.

STEP B-1

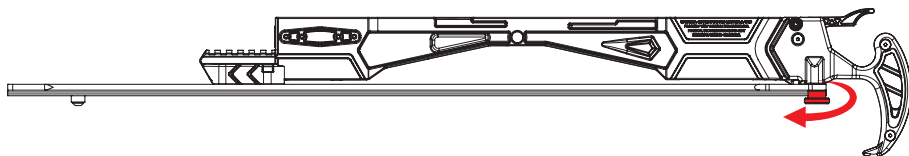

STEP B-2

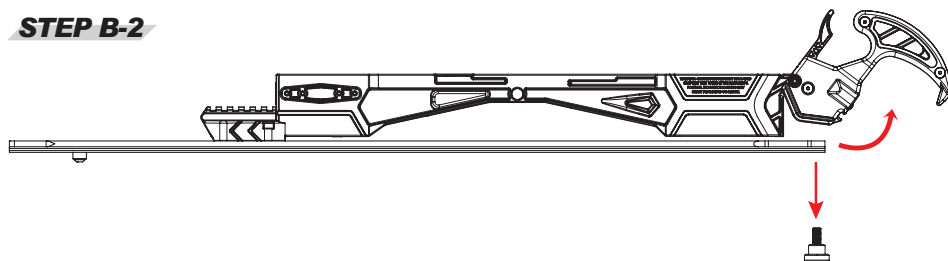

STEP B-3

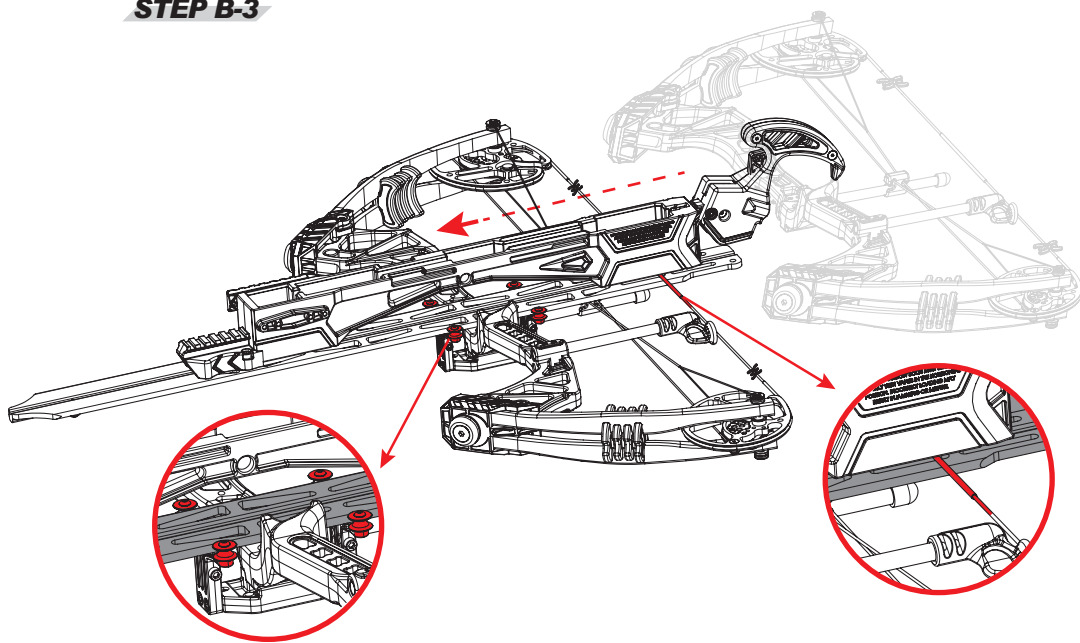

STEP B-4

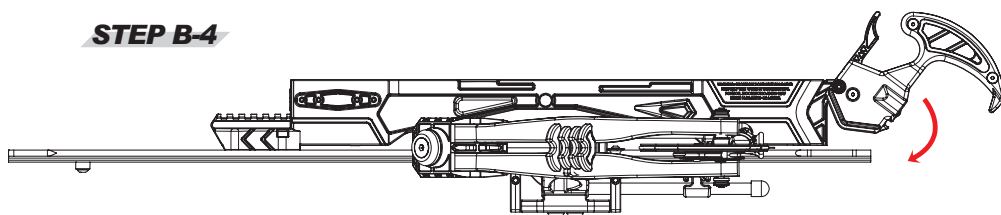

STEP B-5

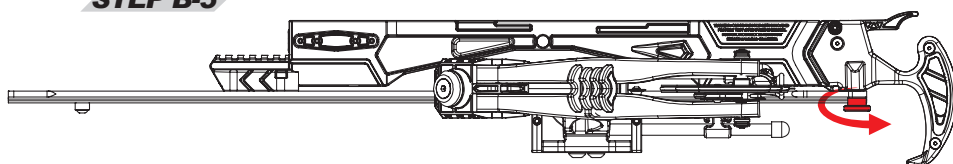



Assembly completed.

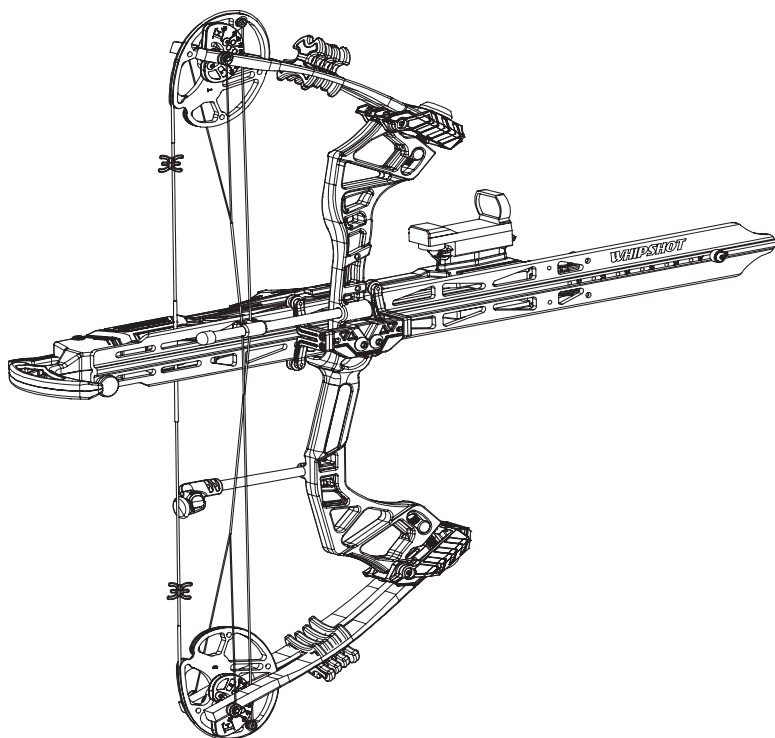

NOTE:

Slightly adjust the two screws under the slide rail to stabilize the magazine.

IMPORTANT : Do not overtighten the screws on the slide rail, it might damage the bracket or cause deformation.

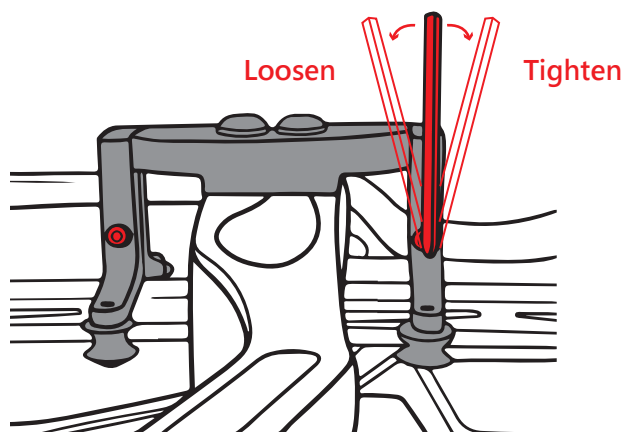

Loading the Arrows

- 1** Place 6 arrows into the magazine. Always check to make sure that the nocks are properly oriented perpendicular to the string.

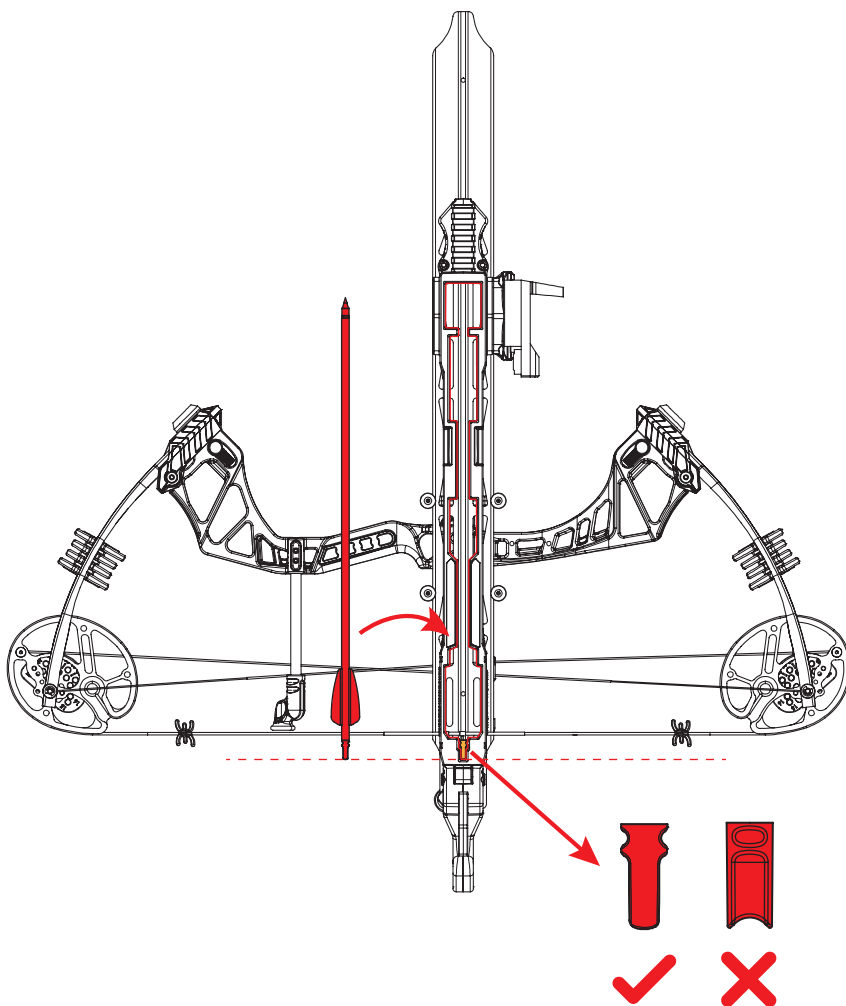

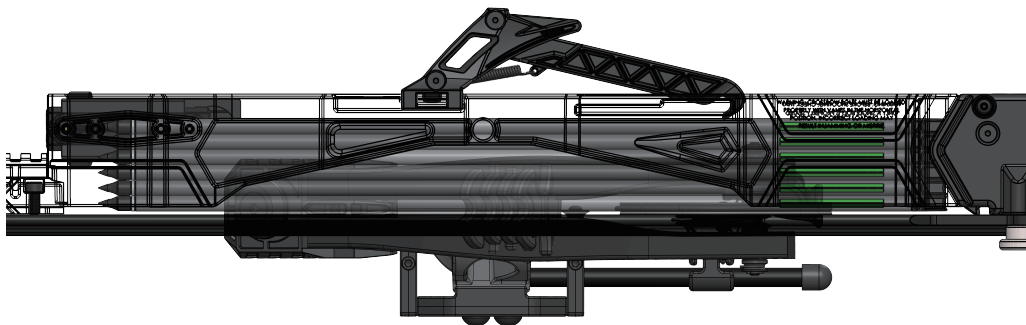

2

Once the arrows are loaded, place the Arrow Retainer onto the arrow stack and slide it backwards into place.

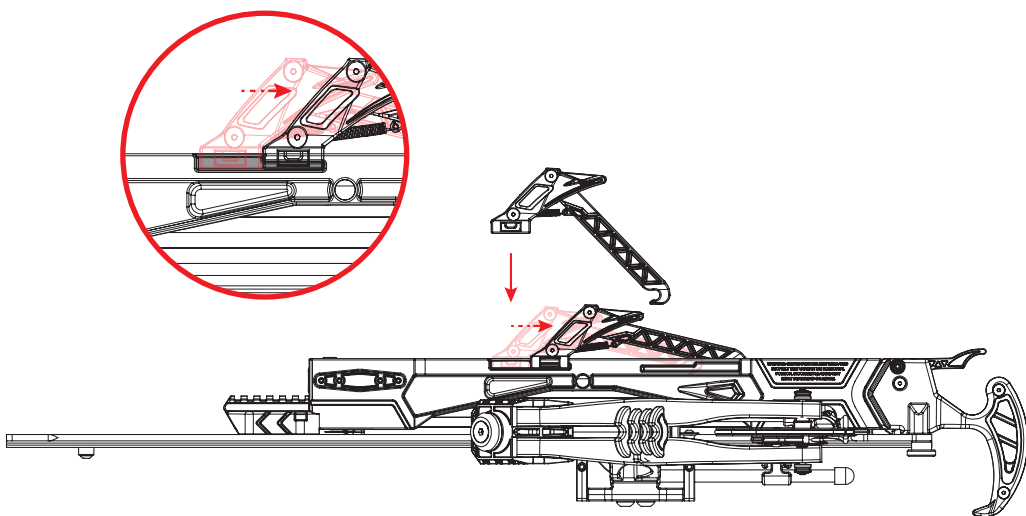

Operation Guide

A

DRAWING YOUR ANVIL COMPUND BOW WITH WHIPSHOT MAGAZINE :

Hold the handle and draw the magazine to the very end until you hear a "clunk" sound.

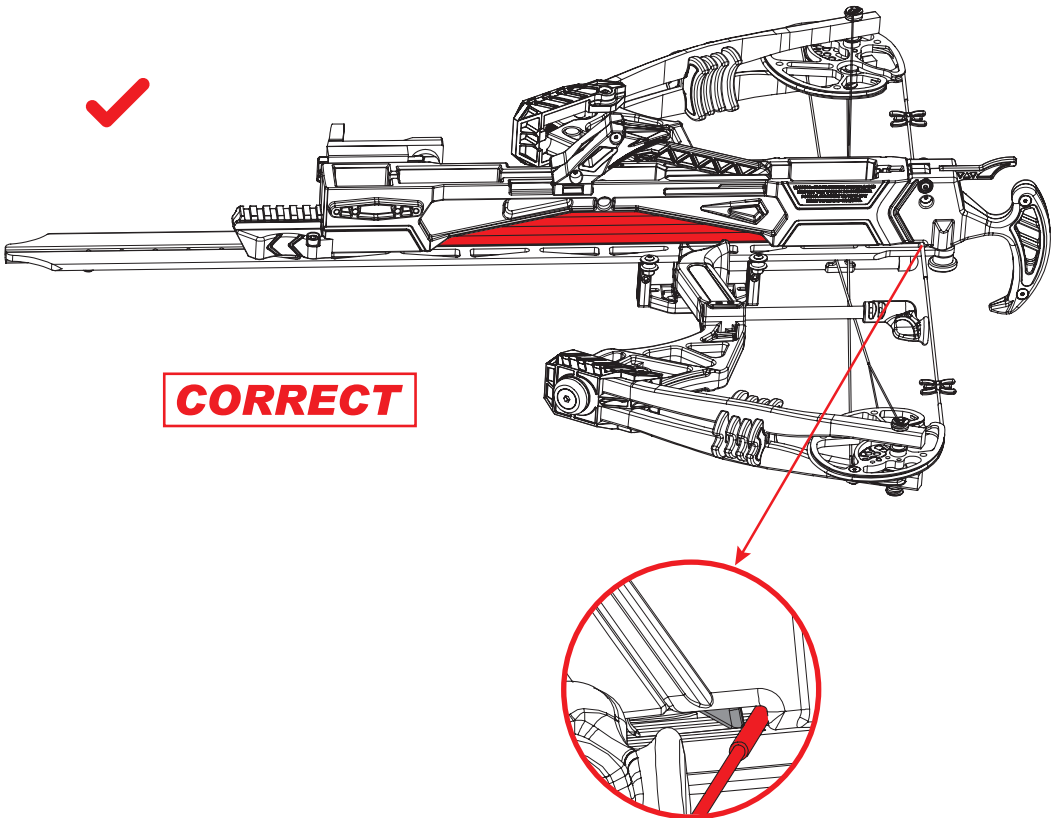

IMPORTANT : Before using your WHIPSHOT bow, apply a light coat of bow wax to the strings.

Troubleshooting

TROUBLE SHOOTING FOR A JAMMED ARROW:

When you draw your bow without pulling the magazine completely to the end, the string will push an arrow to the front. When this happens, slowly and evenly lower the bowstring back into position and then pull the arrow out from the front of the magazine. Do NOT shoot the bow until the mispositioned arrow has been pulled out, otherwise it will jam magazine or cause injury to you and damage to your bow.

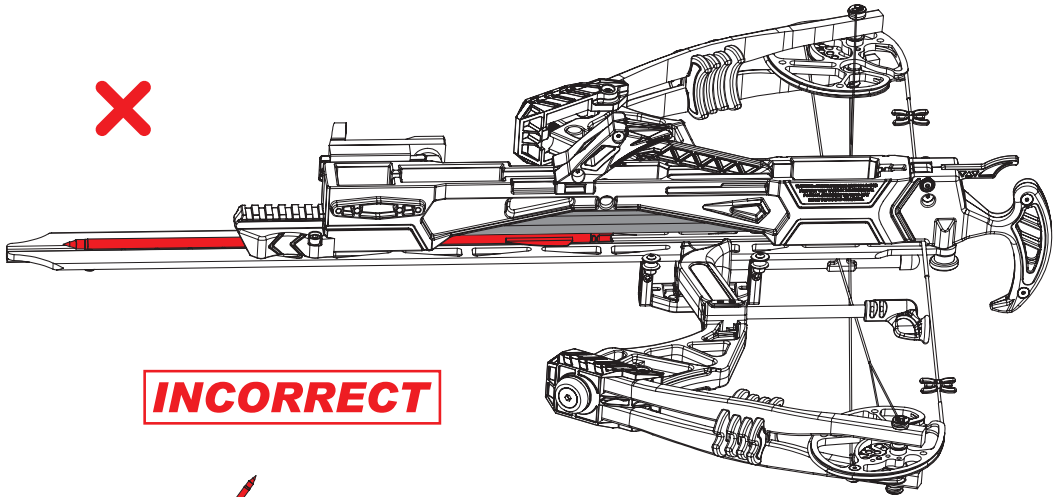

INCORRECT

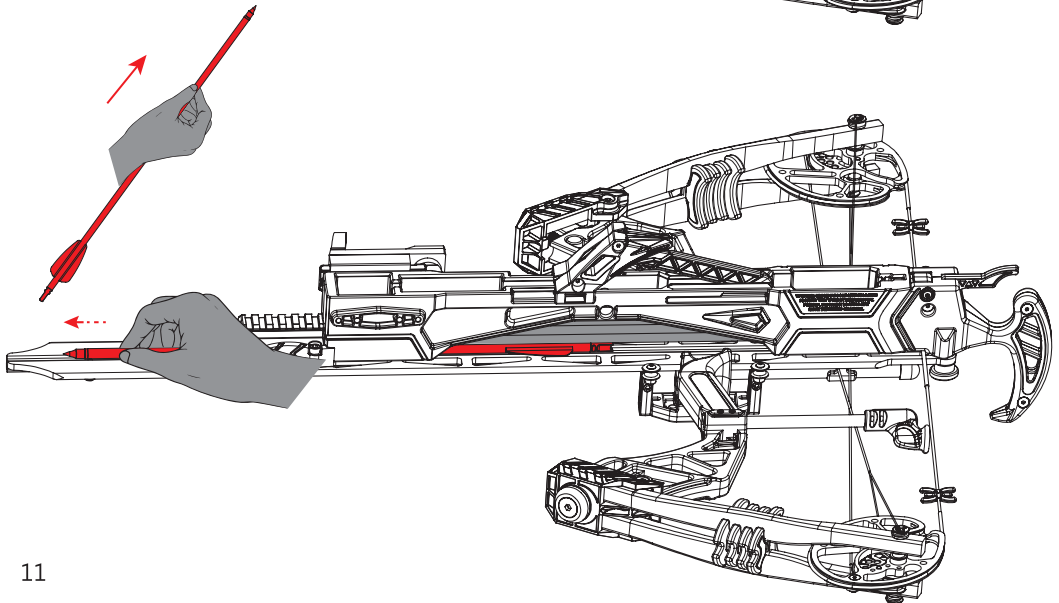

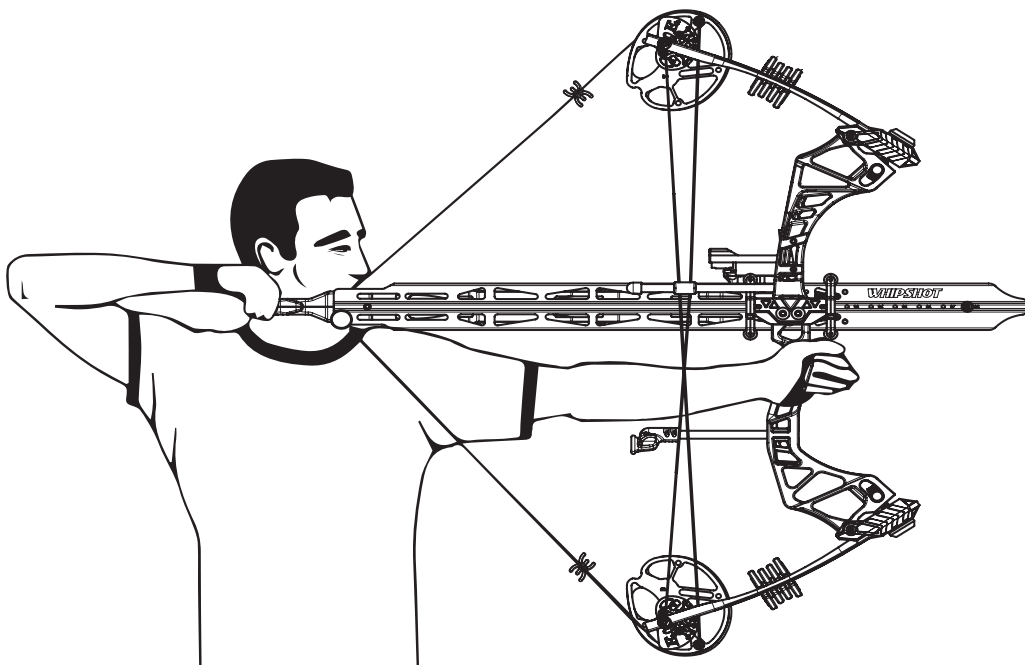

WARNING:

- Make sure everything has been installed properly before shooting, if there is anything wrong, stop using it immediately.
- When you draw the bow, make sure the arrows are placed properly in the magazine and on the flight groove.
- Only shoot a single arrow each time.
- Keep your finger away from the flight groove. failure to do so may cause serious injury.
- Keep your finger away from the trigger to avoid misfired while drawing the bow.
- Do not shoot the bow without installing the Arrow Retainer
- Do not shoot with an empty magazine or dry-fire, shooting without arrow will cause damage to your bow and magazine.

Setting Up Adjusting WHIPSHOT

Draw Length (Cam) Adjustments :

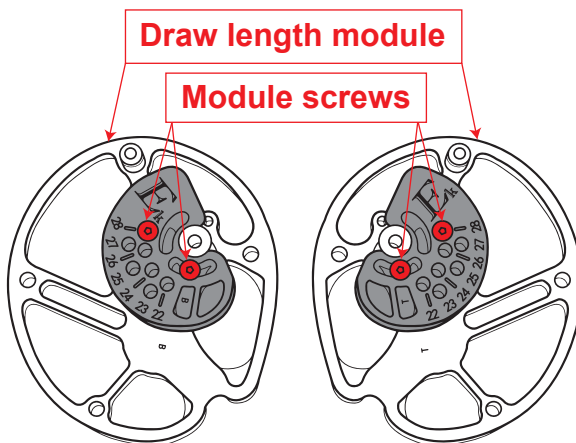

Check the following chart to know which letter fits your draw length. Make a note of the letter on the Module by the setting mark. To rotate the draw length module, you will first need to remove the two Allen head module screws. Lift and rotate the module to the desired position and replace and tighten the screws in the appropriate positions on BOTH cams.

DO NOT draw the bow without the draw length module in place and secured. (Be careful to avoid over-tightening the screws, as this can strip the threads and is not covered under the warranty.)

NOTE:

The default setting for the WHIPSHOT draw length is 28", minimum draw length is 22". Upper module will be marked with "T", lower module will be marked with "B".

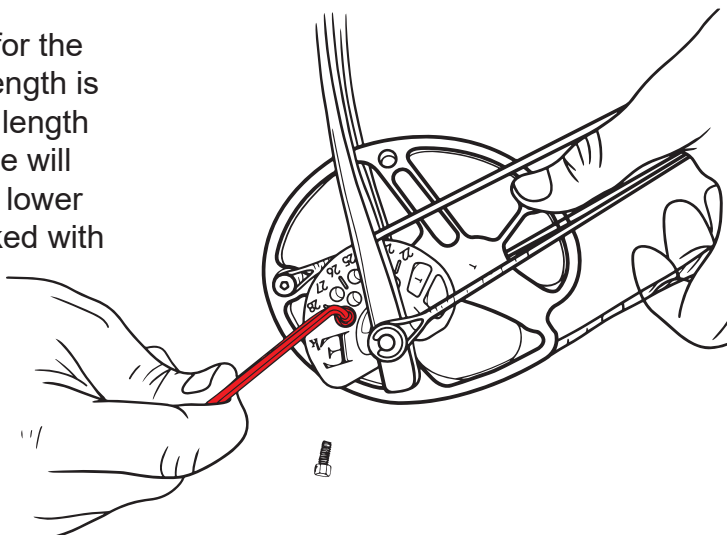

Draw Weight Adjustment

The default setting for the draw weight is 30lbs. minimum draw weight cannot be adjusted lower than 16lbs. You can adjust the draw weight of the bow by turning the Limb Mounting Bolts on the upper and lower end of the riser. **(NO more than 3 complete turns each.)**

Be sure the Limb Mounting Bolts are turned an equal number of turns to maintain proper adjustment. Do not loosen the Limb Mounting Bolts more than 3 turns. Loosening the Limb Mounting Bolts more than 3 turns can cause damage to the bow and / or personal injury. 1 full turn on each Limb Mounting Bolt is approximately 3~5 pounds of draw weight.

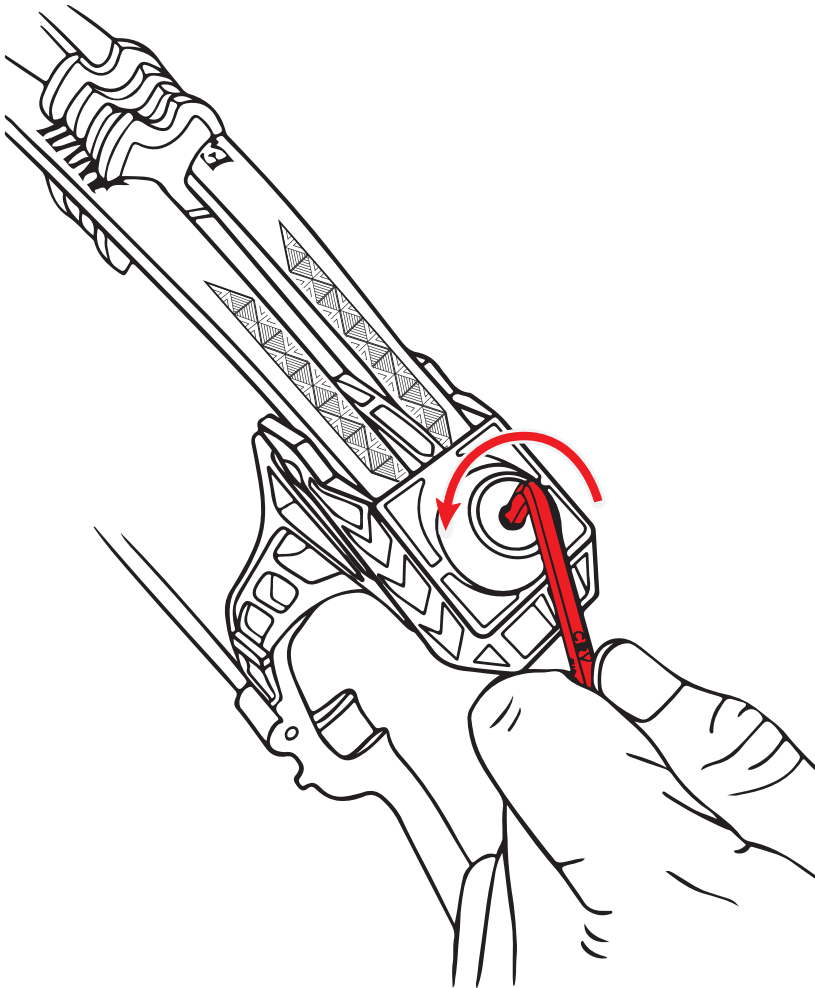

<i>Draw Length</i>	<i>Draw Weight(0)</i>	<i>Limb Bolt Back-off-# of Turns</i>						
		1	2	3	4	5	6	7
28	52	49	44	40	36	32	27	23
27	50	47	43	38	34	30	26	22
26	49	46	42	37	33	29	25	21
25	46	43	39	35	31	27	23	19
24	44	41	37	33	28	25	21	17
23	41	38	34	30	26	23	19	15
22	38	36	32	29	25	22	18	14

COMPOUND BOW MAINTENANCE

It is recommended that you have the bow professionally inspected and serviced on a regular basis. You may need to have this performed more or less often depending on the amount you use the bow.

- Apply a light coat of bow wax to the string and cables periodically.
- Replace worn or frayed strings immediately to avoid a breakage that can damage the bow and / or cause personal injury.
- Store the bow in a cool dry place. Avoid high heat and high humidity areas.
- After using your bow in rain or other such situations it is recommended to dry the bow and apply a light coating of oil to the cams and axles.
- Never Dry-Fire your bow. (Drawing the bowstring and releasing it without an arrow) Dry-Firing can cause damage to the bow and / or personal injury. If a Dry-Fire happens, check the entire bow for damage. Including paying careful attention to the condition of the limbs, string, cables and cams, as well as the rest of the bow. Damage occurring due to a Dry-Fire is not covered under any warranty.

REPLACING THE STRINGS

If your string needs replacing, it is best to go to your local dealer and have it done by experts. Always be sure that the string you replace it with is of the correct length and material for your bow.

WARRANTY INFORMATION

Subject to the terms, conditions and limitations outlined below, we guarantee 1 year warranty service to the original purchaser for our compound bows against defects in materials and workmanship that adversely affect the bow's operation. However, bow strings, cables, cable slides, sleeve bushings, bearings, cosmetic appearance and component parts and those which are subject to a variety of conditions in normal use and considered to be consumable parts will be excluded.

This limited warranty will be void if the following occur :

- Damage is caused by dry-firing or by using underweight arrows / bolts
- The instructions in the owner's manual are not followed. The bow or any of its parts or accessories are altered from their original state.
- The bow has not been maintained properly
- Failure or damage was caused by improper calibration or by abnormal use

Please carefully package and return the product, transportation charges pre-paid to your dealers or distributors. All accessory items must be removed from the bow prior to shipping. If after examining a returned product, the dealer determines that the product is not subject to this limited warranty, product repairs can be provided at then-current repair rates informed by the dealer.

Warranty Registration must be mailed within 10 days of purchase to validate the warranty.

Warranty Registration must be mailed within 10 days of purchase to validate the warranty.

Dealer's contact information :

Model Number/Name

Date of Purchase

Purchaser's Name

Address

City

State

Zip Code

Email

Phone Number

